

Approximate Gross Internal Area
469 sq ft / 44 sq m

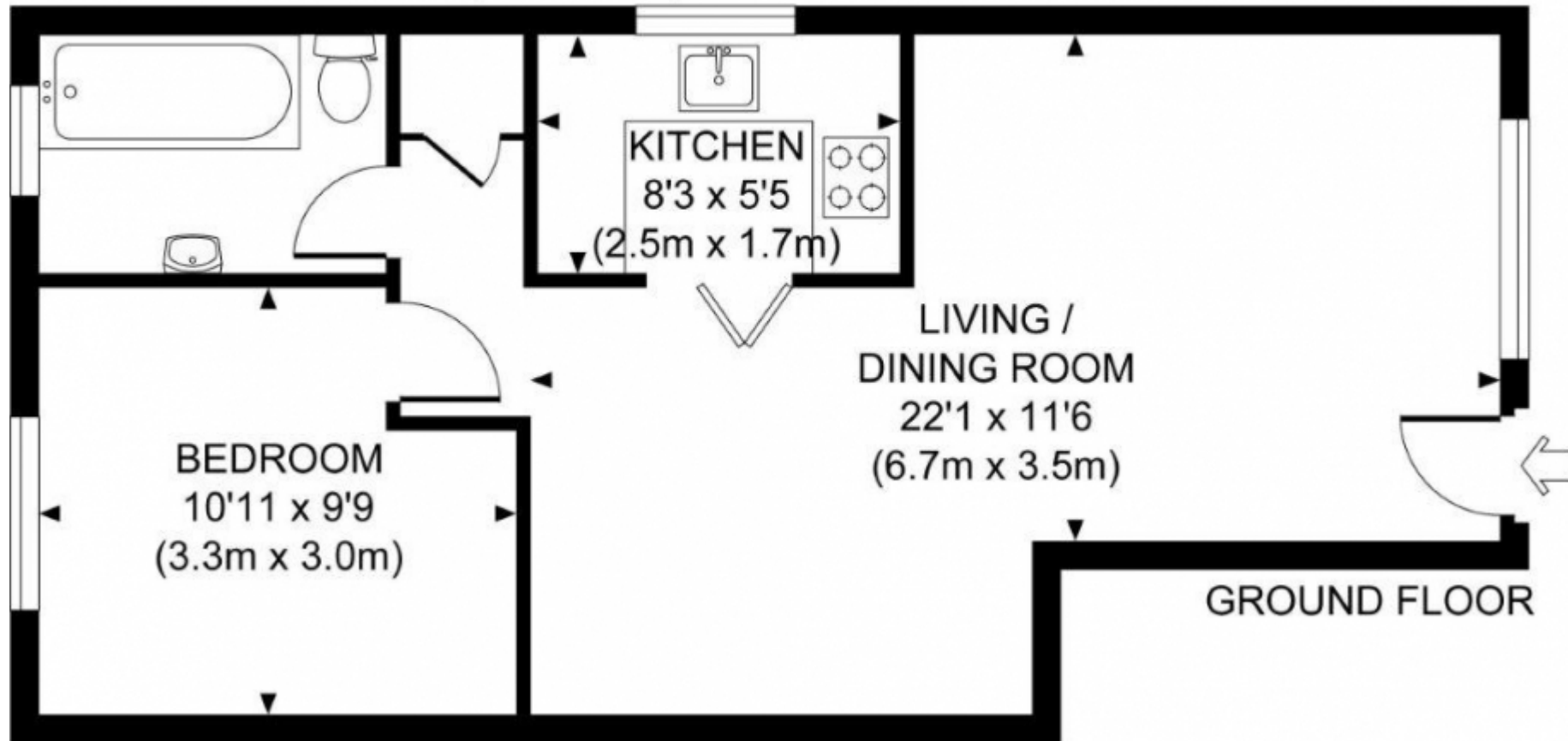

£675 PCM

Hoylake Close, Ifield

Ground Floor Flat | 1 Bedroom | 1 Bathroom

01293 821143



www.dedmanlettings.co.uk

Step Inside

Key Features

- Double glazing
- Gas central heating

Property Description

One double bedroom ground floor flat in Ifield

Main Particulars

Situated in Ifield close to fastway bus service with good access to all ammenities in Crawley. One bedroom ground floor flat, lounge, separate kitchen, bathroom with bath and shower above. Allocated parking.

Telephone: 01293 821143



www.dedmanlettings.co.uk