



£720 PCM

Mill Lane, Ashington

Studio | 1 Bedroom | 1 Bathroom

01293 821143



[www.dedmanlettings.co.uk](http://www.dedmanlettings.co.uk)



# Step Inside

---

## Key Features

- Village location
- Fitted kitchen with modern appliances
- Fitted cupboard in bedroom
- Shared garden and car park
- All bills and wifi included except electric

## Property Description

Converted studio apartment in village of Ashington. Fitted kitchen with modern appliances. The rental of £720pcm INCLUDES ALL BILLS except electric which is on your own metered supply.

## Main Particulars

Dedman Lettings is pleased to offer this converted studio apartment in a lovely country house in the village of Ashington. This property boasts a fitted kitchen with modern appliances, lounge/bedroom area with fitted cupboard and a bathroom with shower, toilet and hand basin in fitted unit. The property has a shared garden and car park.

The rental of £720pcm includes all bills except electric which is on your own metered supply.

Available mid December.



**Corn The Mill House Mill Lane, Ashington West Sussex RH203BX**

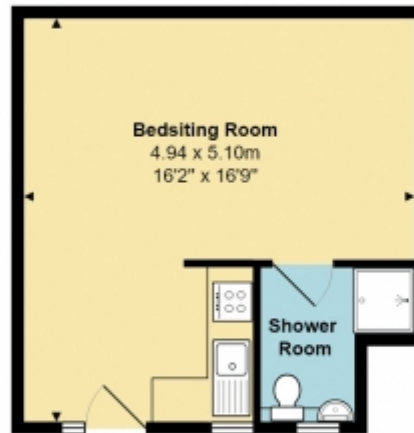

**Total Area: 24.4 m<sup>2</sup> ... 262 ft<sup>2</sup>**

Whilst every attempt has been made to ensure the accuracy of the floor plan shown, all measurements, positioning, fixtures, fittings and any other data shown are an approximate interpretation for illustrative purposes only and are not to scale. No responsibility is taken for any error, omission, miss-statement or use of data shown.

This floorplan is for illustrative purposes only and the location of doors, windows and other items are approximate.

Telephone: 01293 821143



[www.dedmanlettings.co.uk](http://www.dedmanlettings.co.uk)